





GREENSPRING AVENUE

YELLOWWOOD AVENUE

AVENUE

TAMARIND ROAD

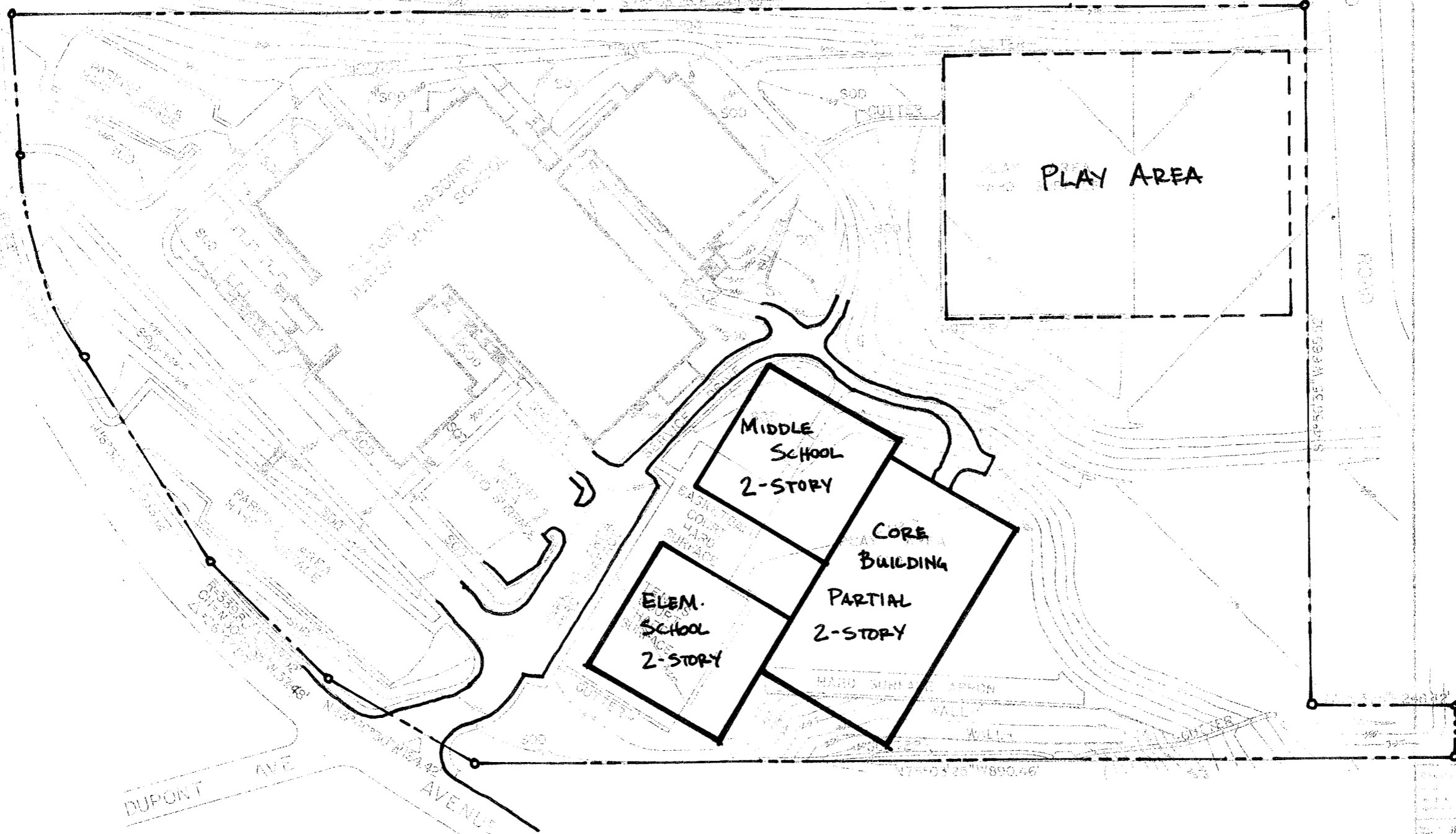

KIPP USIMA VILLAGE ACADEMY - NEW BUILDING - OPTION 2

G/W/O, Inc./Architects  
28 AUGUST 2007

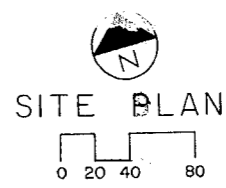

SITE PLAN

GREENSPRING JUNIOR HIGH SCHOOL  
1701 GREEN SPRING AVENUE  
SCHEMATIC  
DATE: 5-17-82  
REVISIONS:

SIGNATURES HERE INDIFY APPROVAL OF SHEETS

CURTIS LANTZ ASST. SUPERINTENDENT	J.L. HENLEY SENIOR ARCHITECT
E.L. SAVAGE COORDINATOR	E.L. SAVAGE DRAWN BY

982820517A0000001



GREENSPRING

YELLOWWOOD

VAN METER

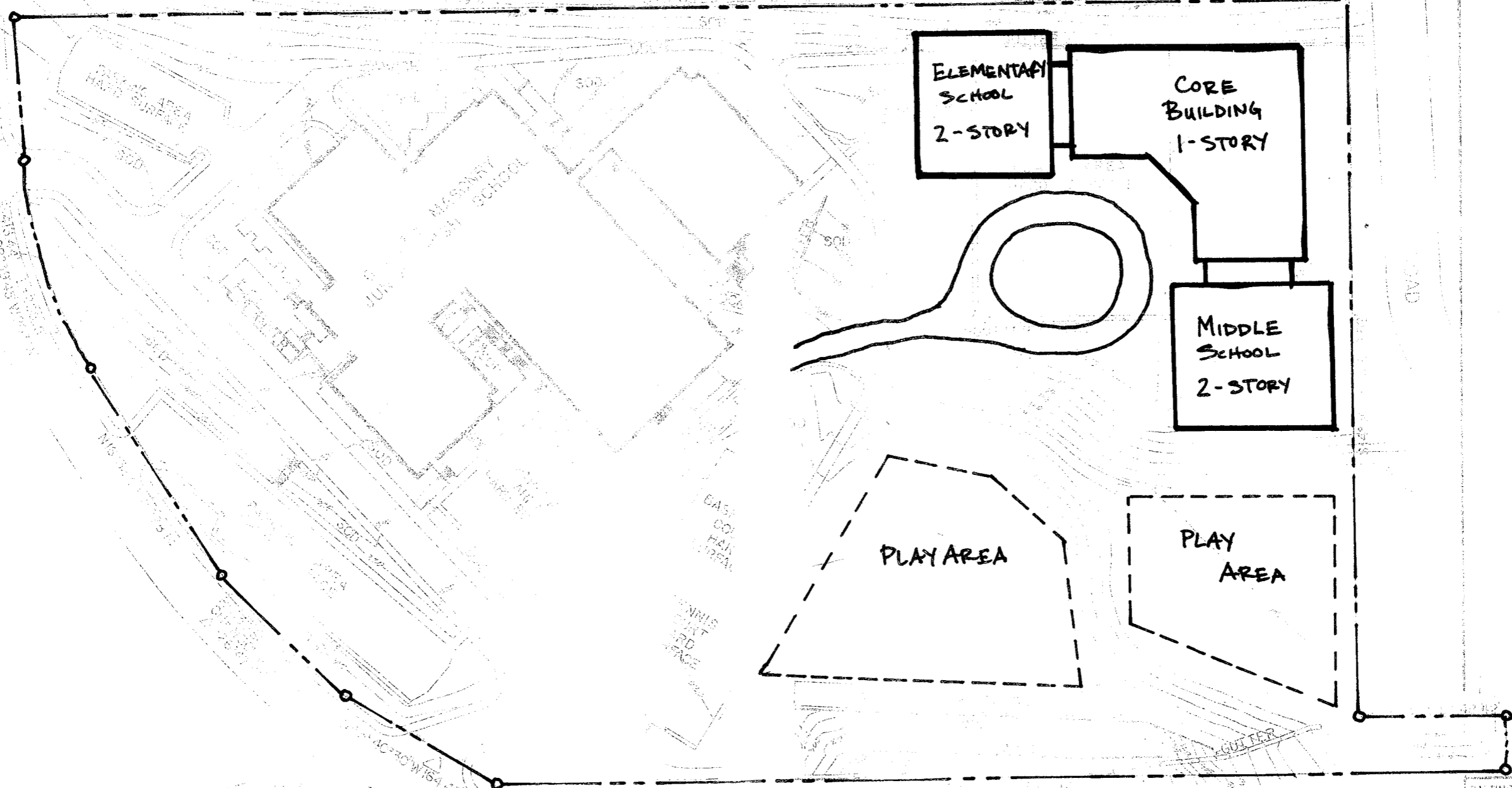

KIPP USIMA VILLAGE ACADEMY - NEW BUILDING - OPTION 3

G/W/O, Inc./Architects  
28 AUGUST 2007

SITE PLAN

0 20 40 60

BALTIMORE CITY  
PUBLIC SCHOOLS  
DEPARTMENT OF PHYSICAL PLANNING  
1200 N. CALVERT STREET, BALTIMORE, MD 21202

PROJECT: GREENSPRING JUNIOR  
HIGH SCHOOL  
1700 GREEN  
SPRING AVE.  
SCHEMATIC PLAN  
AS INDICATED

82

DATE: 8/28/07

BY: J.L. SAVAGE, J.L.L.

COORDINATOR: J.L. SAVAGE  
DRAWN BY: J.L.L.

882820517A0000001

